

LOW & STABLE RESISTANCE

100% MAINTENANCE FREE

UNAFFECTED BY RPM & USE OVER TIME

ADVANTAGES

- Provides consistent low and stable resistance for high current applications
- Requires ZERO grease or routine maintenance
- Robust industrial design provides reliable long lasting performance
- Remains unaffected by RPM or total number of revolutions
Oftentimes surpassing **500M (million) revolutions without demonstrating a change in electrical resistance or performance*

APPLICATIONS

- Rotary welding
- Electro-plating
- Plasma cutting
- Rotary magnetrons/sputtering deposition
- Cable reels
- Lightning strike ground (up to 100,000A tested)
- Electro-polishing

OPTIONS

- Five robust mounting configurations
- Rotary union integration
- Models available to 15,000A+
- [Magswitch](#) magnetic mounts
- RoHS compliant units available upon request



VIDEO – ROTARY GROUND / WELDING CLAMP CONTACT RESISTANCE DEMONSTRATION

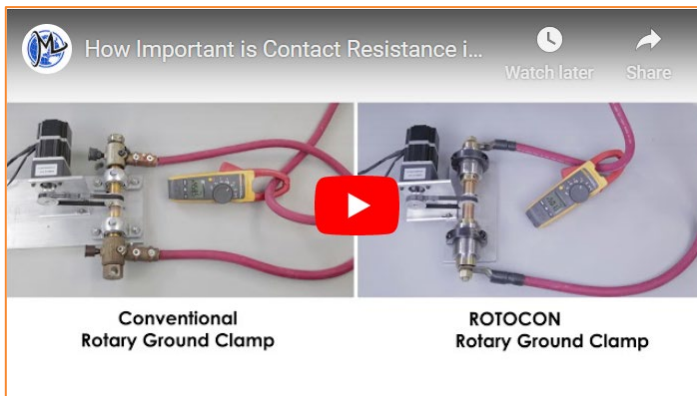

Enjoy the low resistance, zero maintenance benefits your ROTOCON rotary ground provides!



SPECIFICATIONS		NOTES	INSTALLATION NOTE: DO NOT RIGIDLY MOUNT BOTH SHAFT AND BODY AND ENSURE CABLE WEIGHT IS <25 LBS
NUMBER OF CIRCUITS	1	1. SPECIFICATIONS ARE NOT GUARANTEED WHILE IN AN ABSOLUTE MAXIMUM CONDITION	FOR 3D CAD FILES PLEASE CONTACT MERIDIAN LABORATORY
DC CURRENT	400A		
AC[60Hz] CURRENT	350A		
AC[120Hz] CURRENT	300A	2. SHAFT AND BODY ENDS MUST NOT BOTH BE HARD MOUNTED TO ALLOW FOR SMALL NON-CONCENTRIC ROTATION.	
For all other AC frequencies, contact Meridian Lab			
VOLTAGE	N/A	3. PRODUCT DIMENSIONS AND SPECIFICATIONS ARE PROVIDED FOR REFERENCE ONLY, ARE NOT GUARANTEED, AND ARE SUBJECT TO CHANGE WITHOUT NOTICE.	
MAX CONTINUOUS RPM	1,750		
STATIC TORQUE	< 0.50 in-lbs < 56.0 mNm		
OPERATING TEMPERATURE [Non-Rohs]	-20°C TO 70°C		
OPERATING TEMPERATURE [RoHS]	10°C TO 70°C		
HOUSING MATERIAL	304 STAINLESS STEEL		
CONTACT RESISTANCE	<1mΩ		
DYNAMIC RESISTANCE	<1mΩ (0 TO 1,750 RPM)		
WEIGHT (±15%)	1.3 LBS		

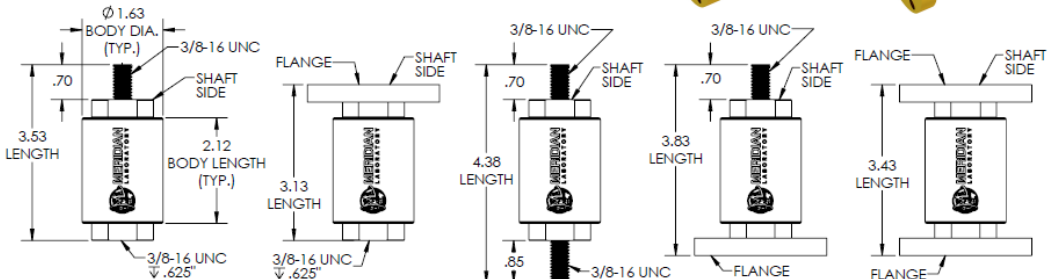
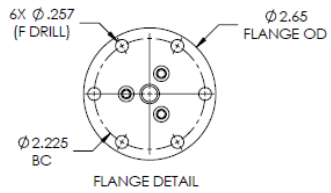

PART NUMBER GUIDE

ERG - 400 - - -

- 0 = THREADED HOLE
- 1 = THREADED STUD
- 2 = FLANGE (BODY SIDE, SHAFT SIDE)

R = ROHS COMPLIANT
BLANK = NOT ROHS COMPLIANT
FOR ROHS UNITS ADD .050" TO LENGTH DIMENSIONS

ERG-400-01

Hardware Inc.:
2x 3/8" LockWasher
1x 3/8-16 Hex Bolt
1x 3/8-16 Nut

ERG-400-02

Hardware Inc.:
1x 3/8" LockWasher
1x 3/8-16 Hex Bolt

ERG-400-11

Hardware Inc.:
2x 3/8" LockWasher
2x 3/8-16 Nut

ERG-400-21

Hardware Inc.:
1x 3/8" LockWasher
1x 3/8-16 Nut

ERG-400-22

Hardware Inc.:
N/A

This drawing is proprietary to Meridian Laboratory Inc. and may not be copied, disclosed, or distributed without explicit written permission.

SCALE: 1:1.75	MERIDIAN LABORATORY		Rev
DEC. TOL. ±.01 SEC. TOL. ±.1 ANG. TOL. ±1/2	Title: ERG-400 TECHNICAL SPECIFICATIONS		A
Drawn By: JCE	Date: 03/23/2021	Model No.: ERG-400	SHEET 1 OF 1

LOW & STABLE RESISTANCE | 100% MAINTENANCE FREE
UNAFFECTED BY RPM & USE OVER TIME

ROTOCON HIGH CURRENT ROTARY GROUND SERIES

Meridian Laboratory offers a full lineup of single contact, high-current rotary ground clamps that all provide a consistent, maintenance-free contact unaffected by RPM or total number of revolutions. The ERG Series is available both in end-of-shaft and through-bore configurations in a range of amperage levels, dependent on your needs.

Purchase Direct



PHONE
608-836-7571
800-837-6010

EMAIL
info@meridianlab.com

VISIT
2415 N. Pleasant View Rd.
Middleton, WI 53562

SIMPLE INSTALLATION

100% MAINTENANCE FREE

DOES NOT REQUIRE ANY GREASING



Solid Workpiece Attachment

THREADED HOLE



Thread workpiece into unit *

THREADED STUD



Thread into workpiece †

FLANGE



Mount to workpiece ‡

Flexible Cable Attachment

THREADED HOLE

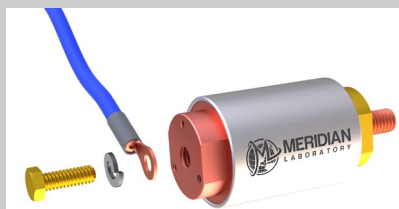

Thread bolt into unit *

THREADED STUD

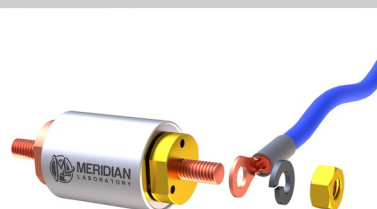

Connect to terminal lug †

FLANGE

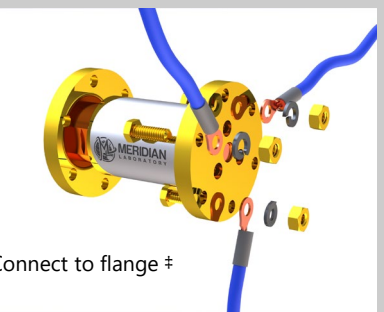

Connect to flange ‡

General Notes:

- Either end of unit can rotate or be stationary
- Can be used in any direction and orientation
- Can be used for the positive (plus) or the negative (ground) end of all electrical circuits
- Accommodates weight (up to 25#) of cables and work pieces, but provide cable strain relief and avoid significant sideloading for optimal performance
- Ensure electrical connections are adequate and solid surface-to-surface contact is made between conductors

* Bolt, nut, and lockwasher provided

† Nut and lockwasher provided

‡ Hardware not included